

A young boy in a striped shirt stands on a rocky riverbank in a lush forest. A large tree with thick roots and a waterfall are visible in the background. The scene is misty and serene.

Our Time on Earth

SPATIAL DESIGN

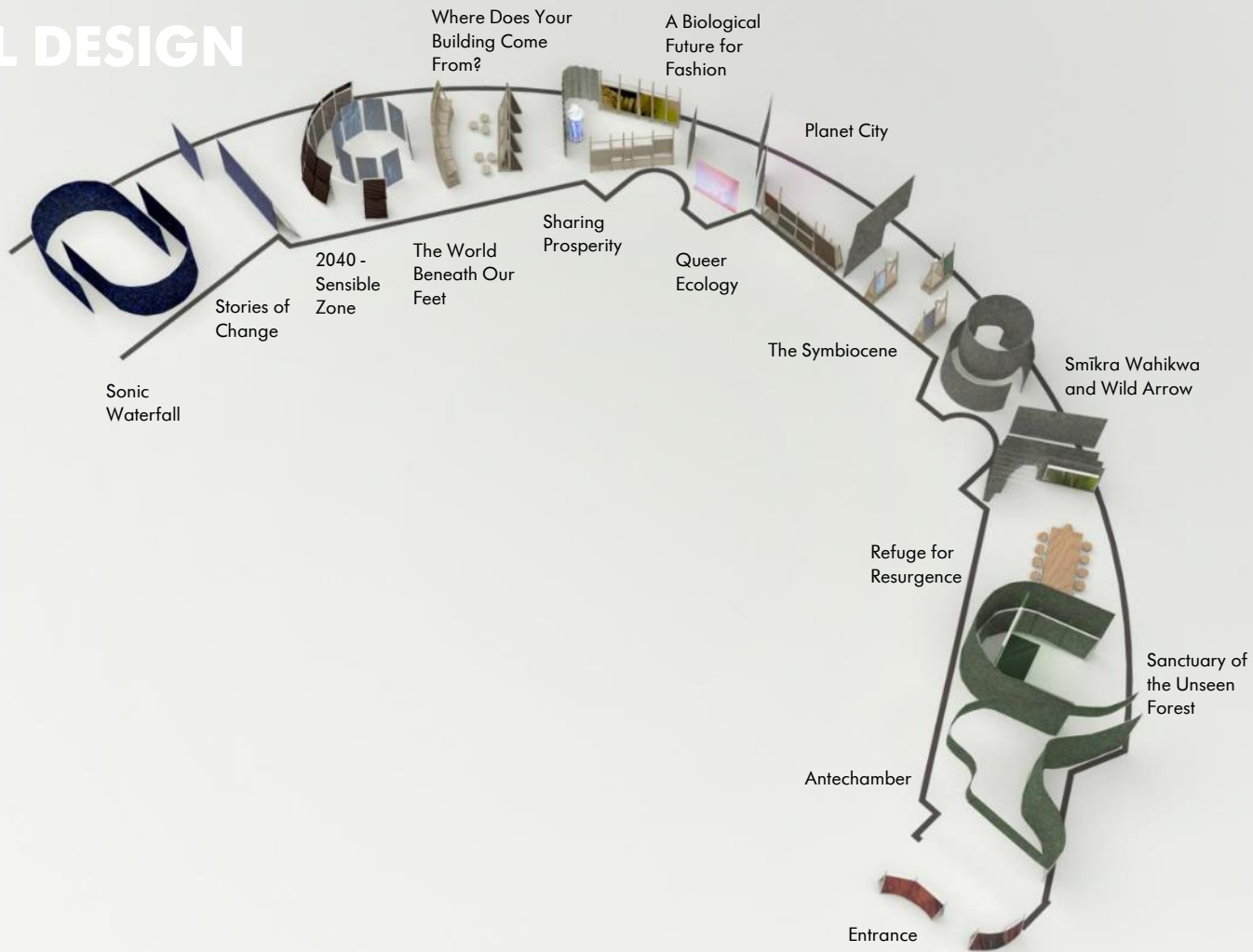

Entrance



© Universal Design Studio

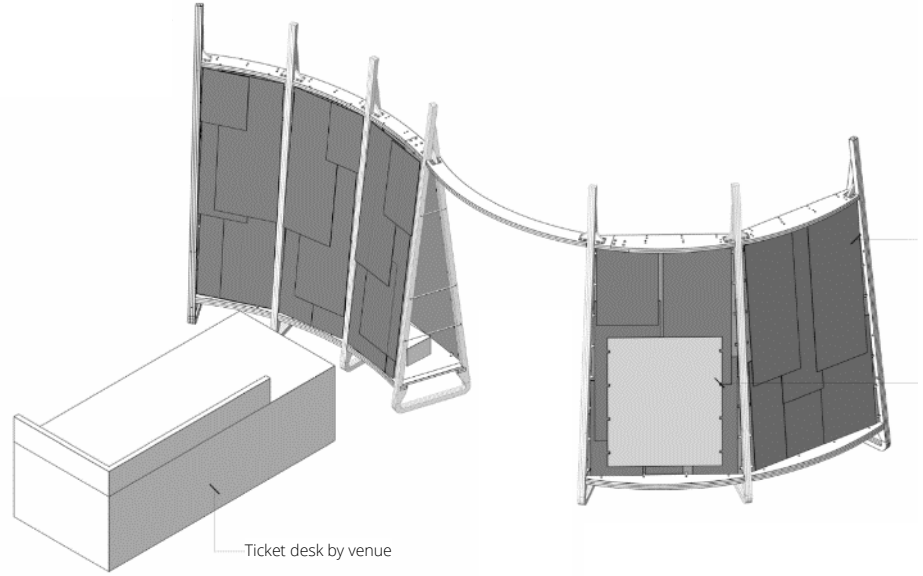

Ticket desk by venue



Plywood
Framework



PineSkins
'Cladding'



Brown Felt
Stretched Fabric



Hemp Linen
Graphic Panel



RAL 7009
Suggested ticket desk
paint colour

Antechamber



© Universal Design Studio



Green Felt
Curtain

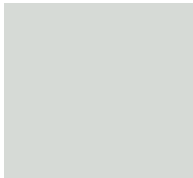

RAL 7047
Suggested wall colour

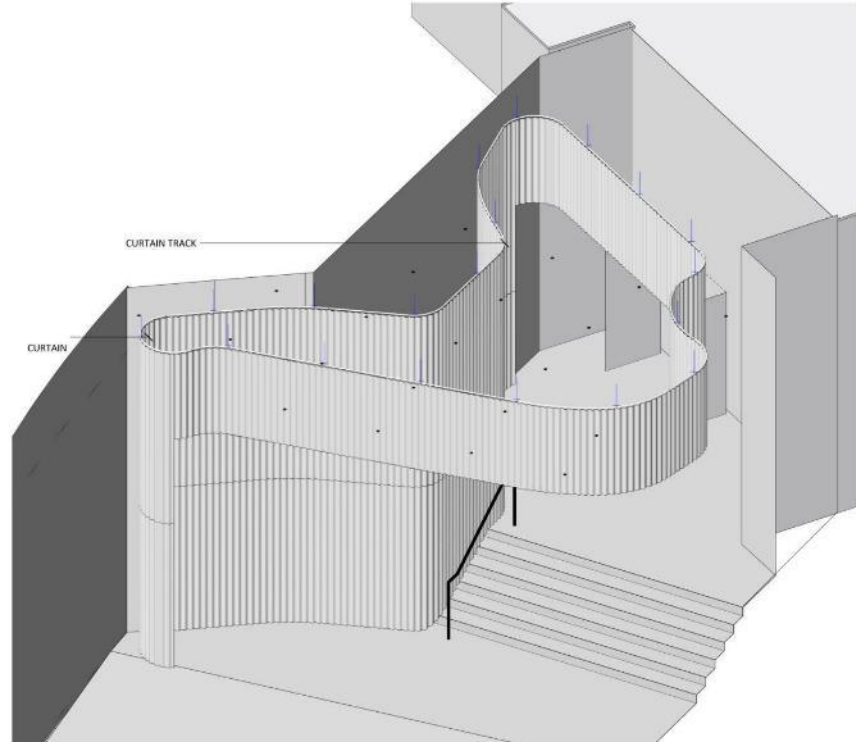

Sanctuary of the Unseen Forest

by Marshmallow Laser Feast & Andres Roberts



© Universal Design Studio



Green Felt
Curtain

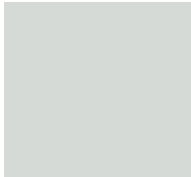

RAL 7047
Suggested wall colour



Plywood
Plinth structure



High Gloss Black Paint
Plinth top paint



Refuge for Resurgence

by Superflux



© Universal Design Studio

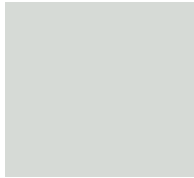

RAL 7047
Suggested wall colour



barbican

Smīkra Wahikwa and Wild Arrow

by Choose Earth & Selvagem



© Universal Design Studio



©Tim P. Whitby / Getty



Brown Felt
Curtain

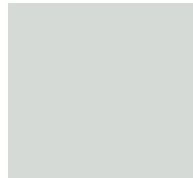

RAL 7047
Suggested wall colour

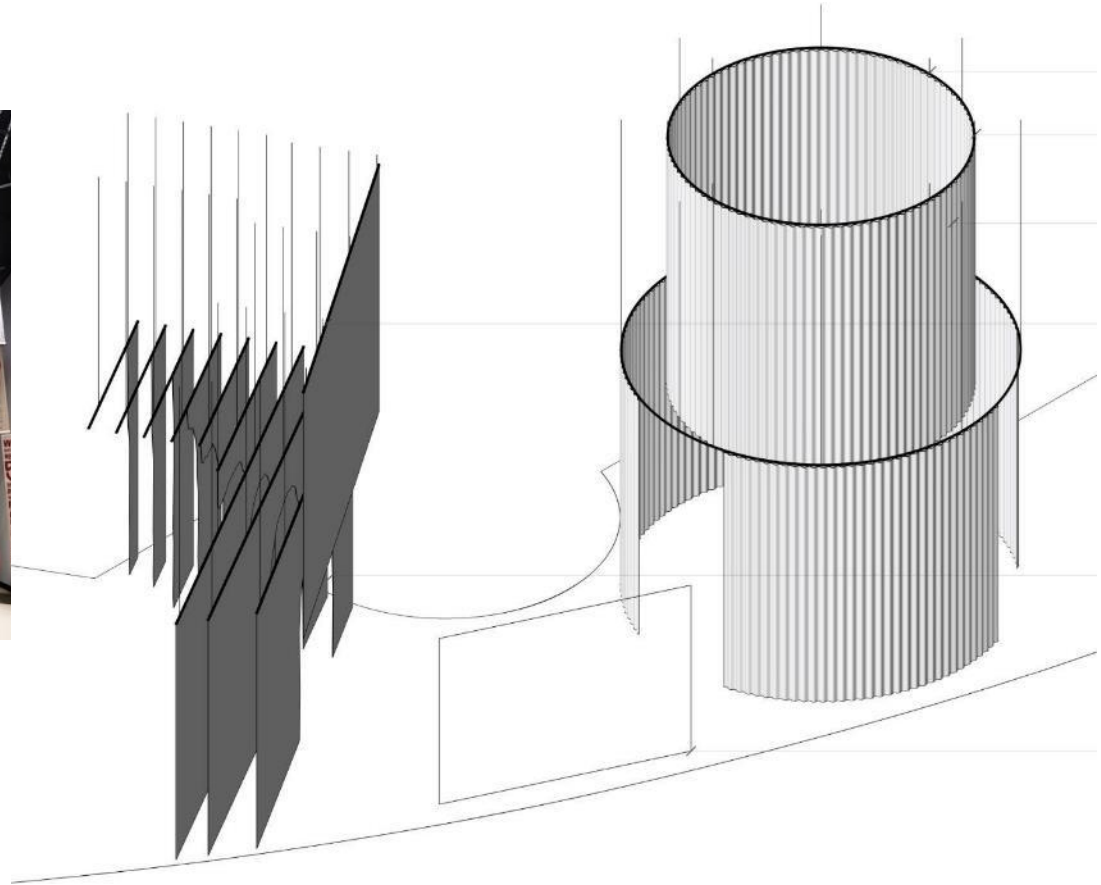

Planet City

by Liam Young



© Universal Design Studio



RAL 7009
Suggested wall colour



Brown Felt
Curtain



Black paint, eggshell
Plinths / panels



Corrugated hemp
Panels

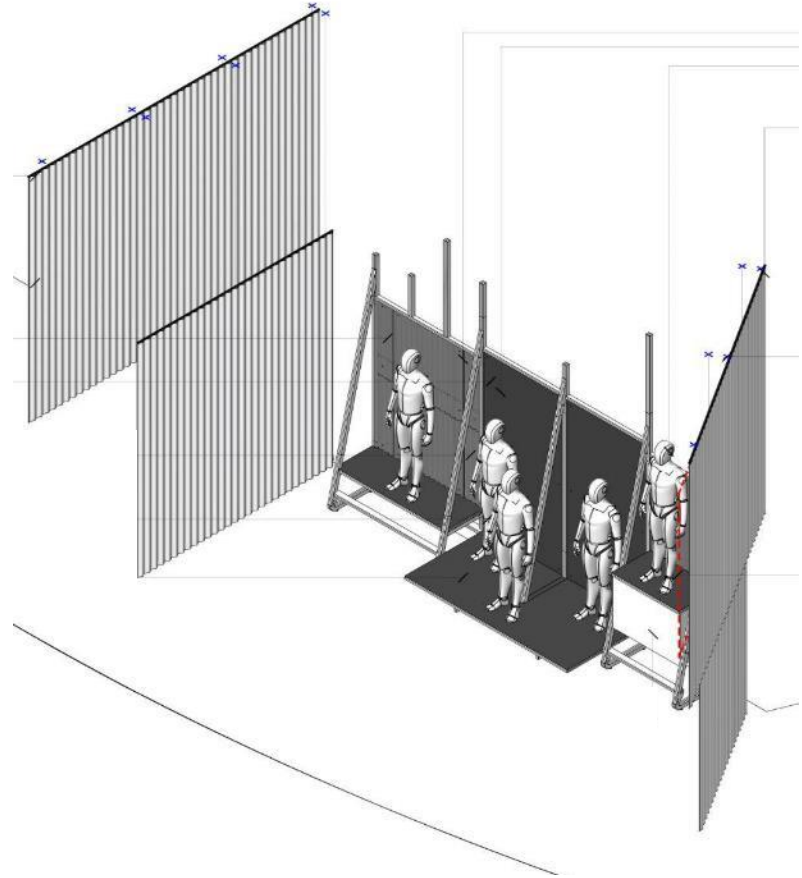

Queer Ecology

by Institute of Digital Fashion & Brigitte Baptiste



©Tim P. Whitby / Getty



RAL 7009
Suggested wall colour



Brown Felt
Curtain

Equipment box to be painted to match if current colour contrasts with floor of new venue

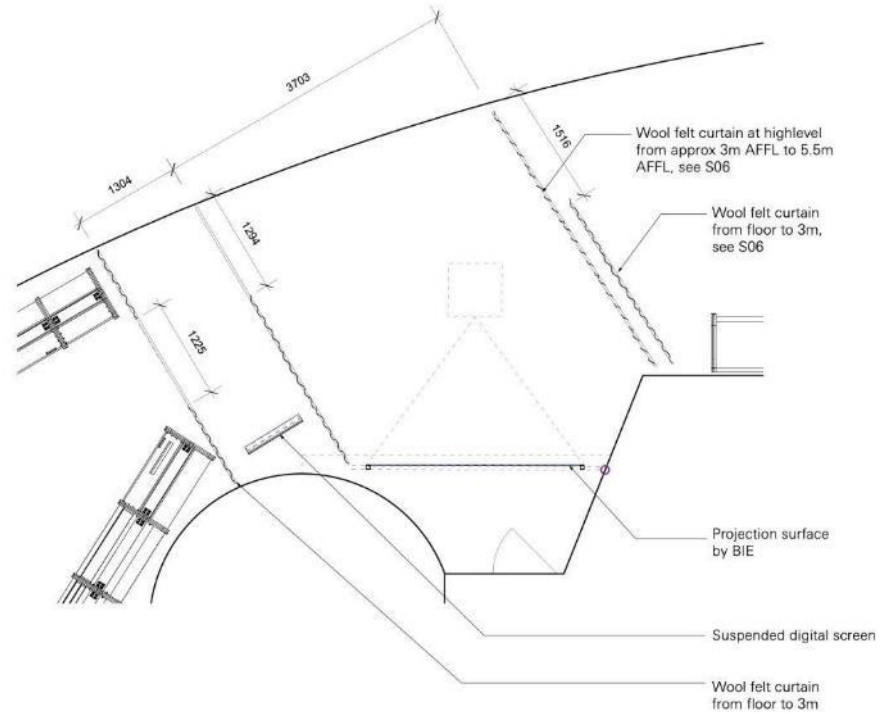

A Biological Future for Fashion

by BIOFABRICATE & Parley



©Tim P. Whitby / Getty



© Fran Taylor



RAL 7045
Suggested wall colour



Plywood
Framework



White paint, eggshell
Inside of display boxes

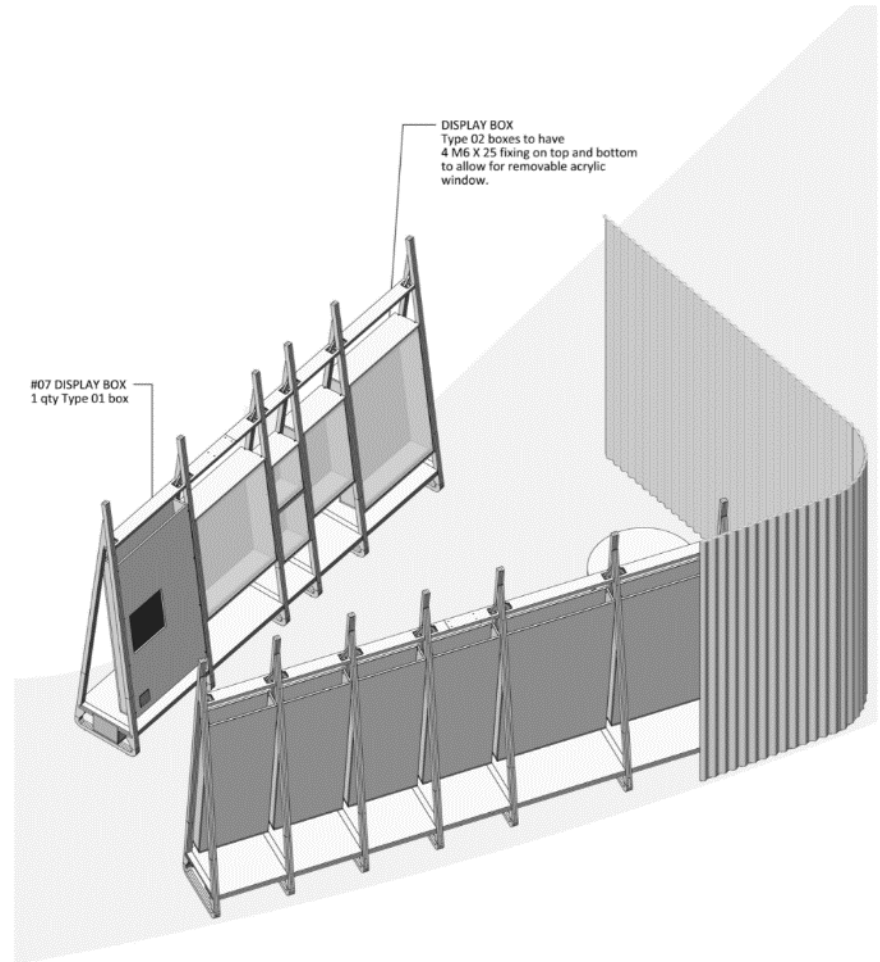

Sharing Prosperity

by Institute for Global Prosperity & DVTK



©Tim P. Whitby / Getty



Plywood
Framework



Black Paint, eggshell
Perforated panels

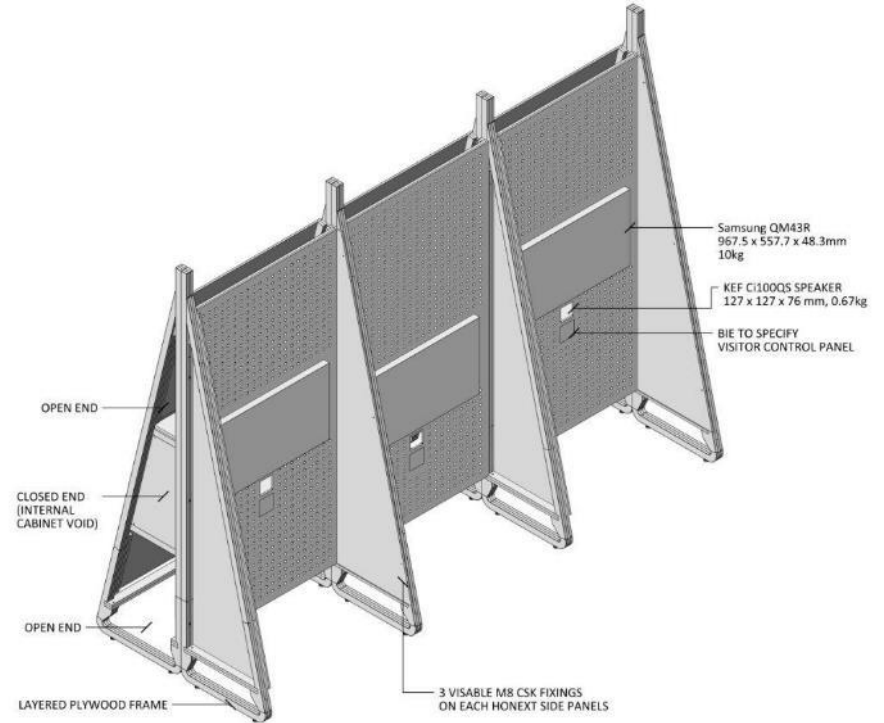

Where Does Your Building Come From?

by Build X



© Universal Design Studio

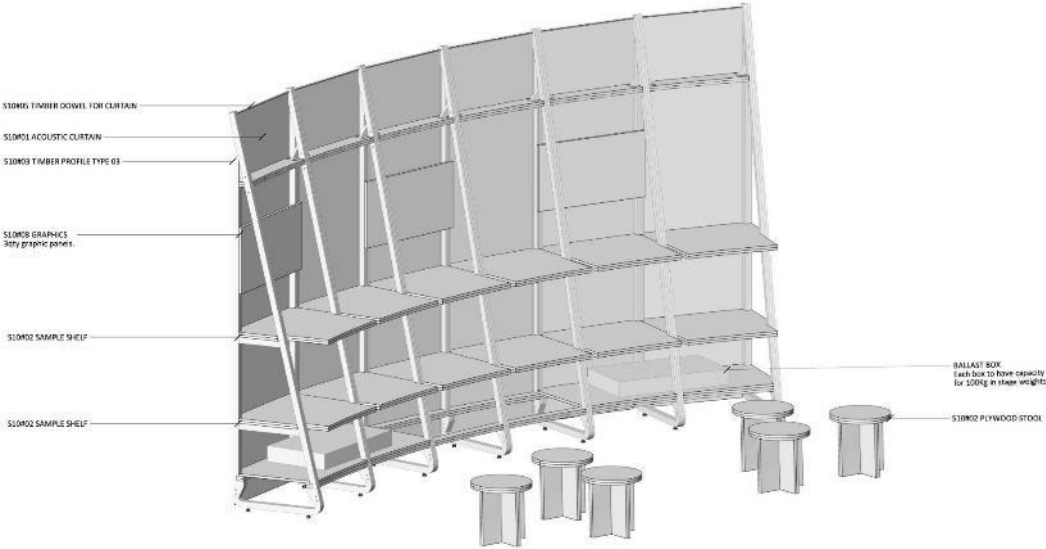

Plywood Framework display boxes



100% New wool Framework

The World Beneath Our Feet

by Holition & George Monbiot



©Tim P. Whitby / Getty



© Universal Design Studio

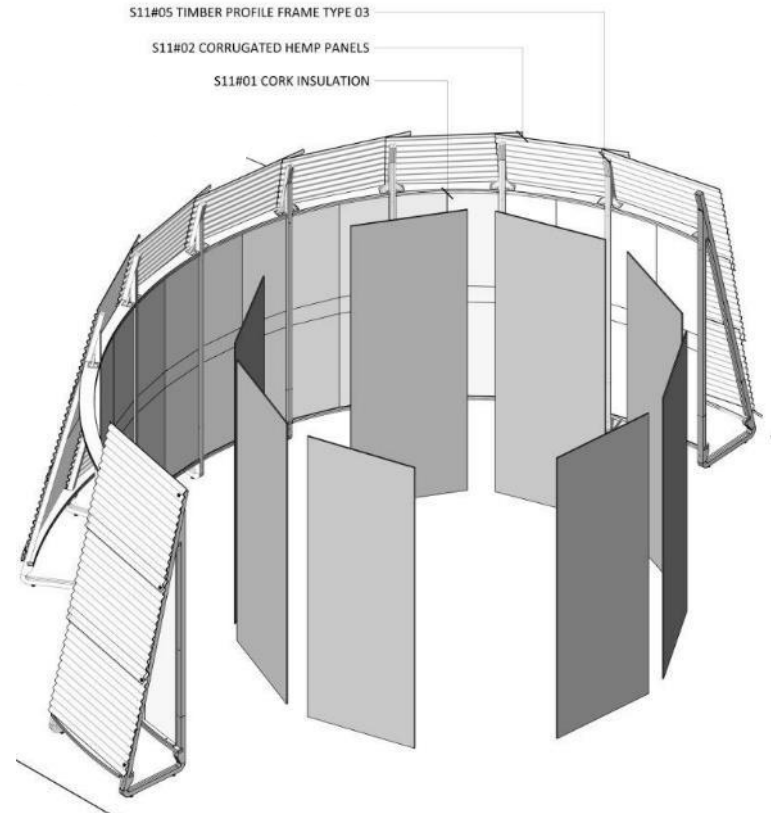

Plywood
Framework
display boxes



100% New wool
Framework



Cork insulation
Framework - back

2040 – Sensible Zone

by Territorial Agency



© Fran Taylor



100% Dutch wool
Felt curtain

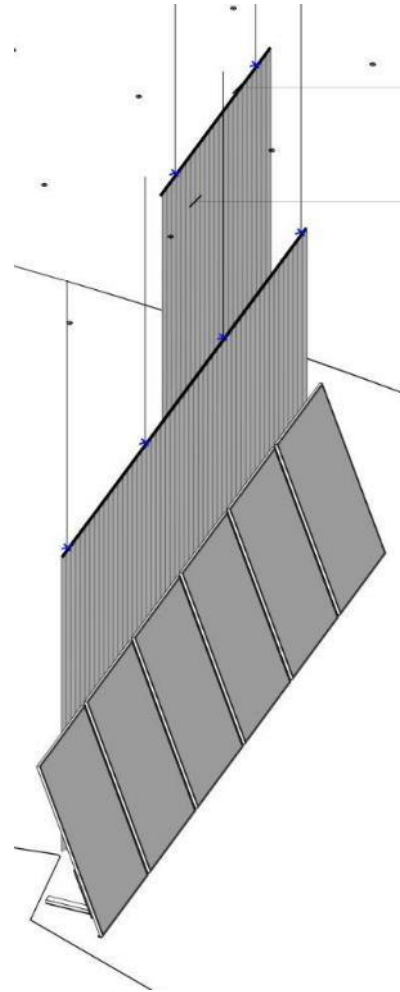

barbican

Stories of Change

by Wallmakers & The Earth Issue



©Tim P. Whitby / Getty



Sonic Waterfall

by Silent Studios



© Silent Studios



100% Dutch wool
Felt curtain

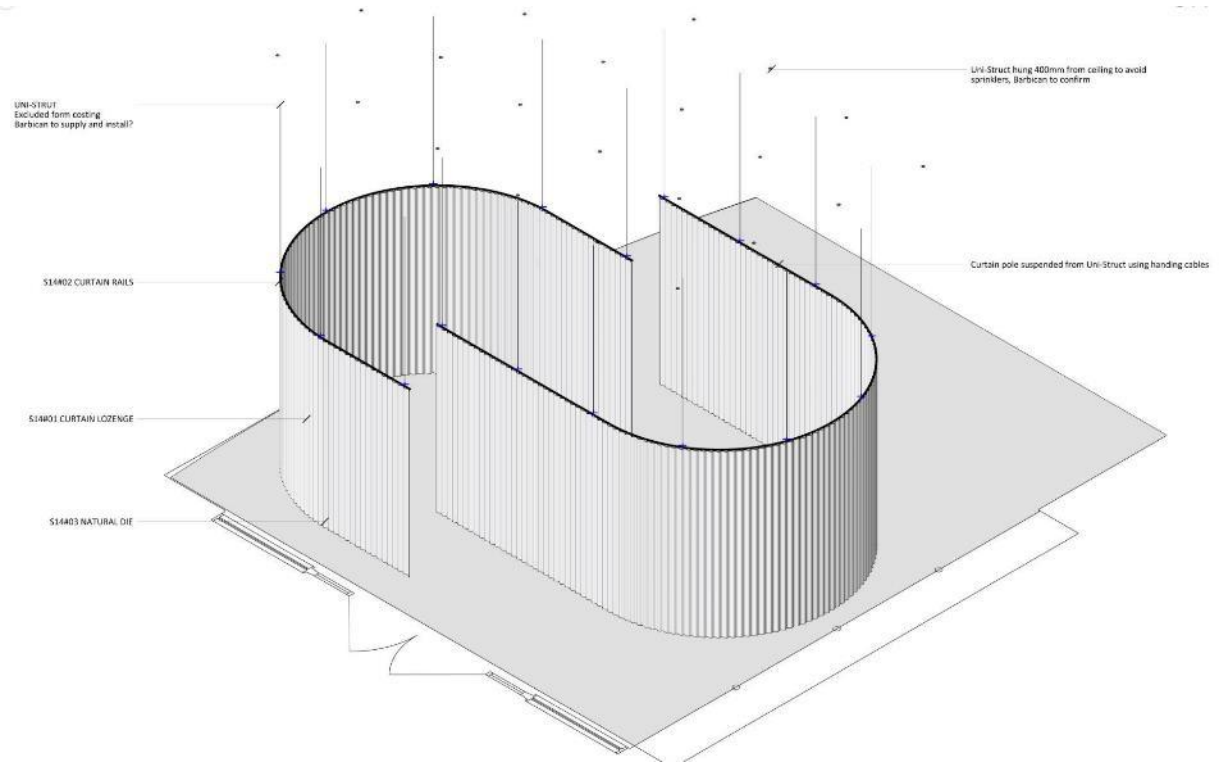

barbican

Noise Aquarium

by Victoria Vesna



© Universal Design Studio



Plywood
Framework

Corrugated hemp board
Framework

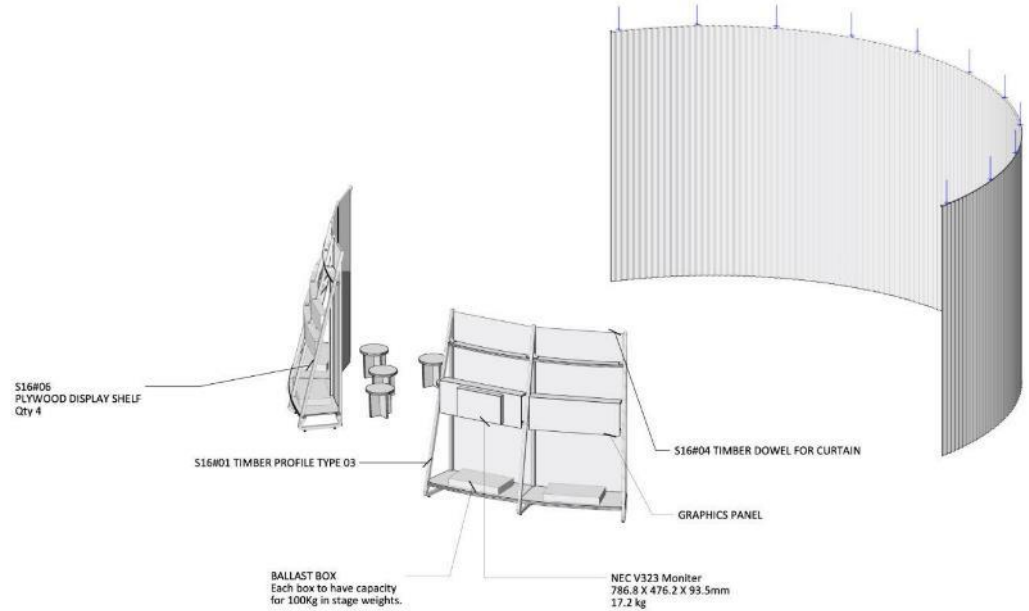

Wither

By Thijs Bierstekker



©Tim P. Whitby / Getty

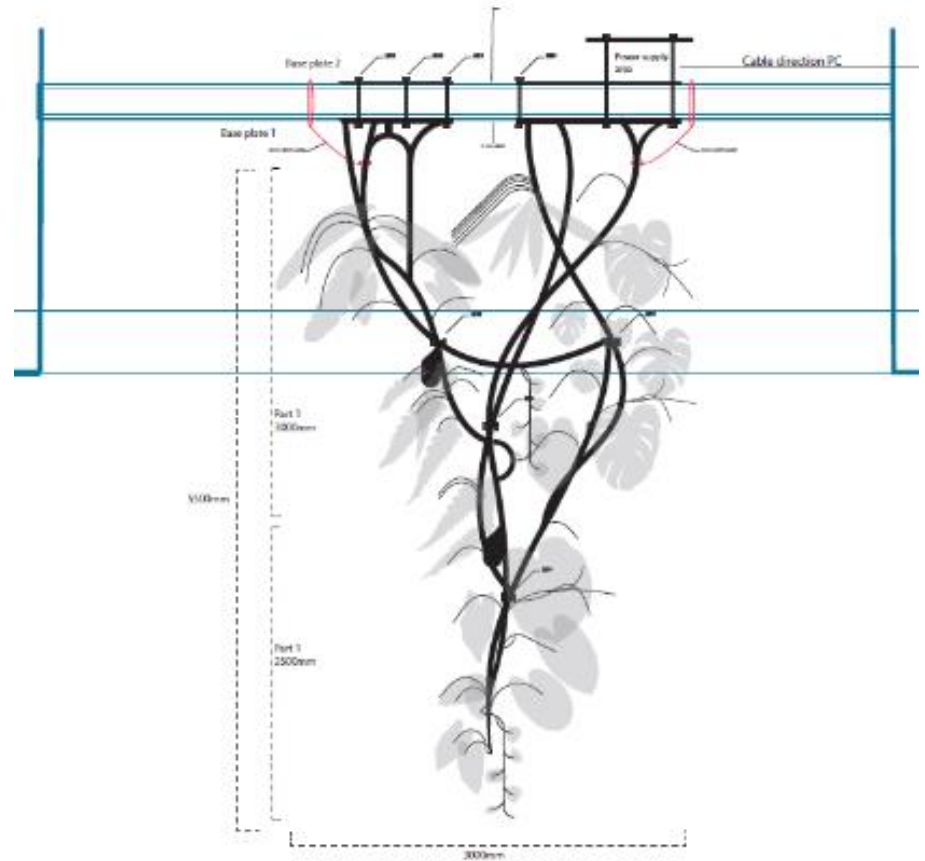

Life Forces

By SPACE 10 & Modem



©Tim P. Whitby / Getty



Plywood
Framework

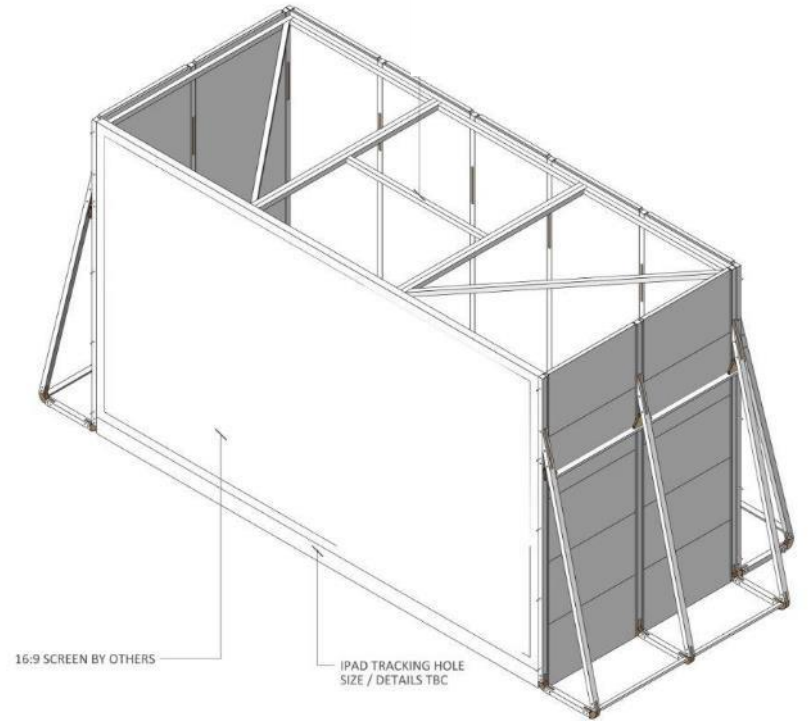

barbican

The Ideal City

By Tin & Ed



© Lorenzo Zandri



Plywood
Wooden dowel rods



Polyester
Base frame

Eyes As Big As Plates

By Riita Ikonen & Karoline Hjorth



© Karoline Hjorth / Riitta Ikonen



© Fran Taylor

MATERIALS



Wool

Wool has several sustainable attributes: it is rapidly renewable, biodegradable, recyclable, and can be produced organically. Durable, water repellent, inherently fire resistant. 100% biodegradable.

Sourcing

All textiles have been sourced from [Ecological Textiles](#), a Dutch company specialising in fabrics, yarns and dyes manufactured and processed in a sustainable way.

The company has been Global Organic Textile Standard (GOTS) certified since 2013, which means it complies with stringent ecological and social criteria.



Brown Felt

Heavy Loden Plain Weave Melange
ET_GW034_M75 (brown)
100% New wool, produced in Europe according to GOTS standards
Fire performance: Fire resistant



Green Felt

Heavy Loden Plain Weave Melange
ET_GW034_M630 (green)
100% New wool, produced in Europe according to GOTS standards
Fire performance: Fire resistant



Indigo Felt

Medium Weight Loden
ET_GW164
100% Dutch wool, dyed with natural indigo
Fire performance: Fire resistant



Dark Blue Felt

Very heavy twill
ET_GW048_20 (dark blue)
100% New wool (mix from conventional husbandry)
Produced and finished in Europe, OEKO Tex dyes
Fire performance: Fire resistant

Contact

Marita Bartelet
info@ecologicaltextiles.com
www.ecologicaltextiles.com

Hemp

Considered to be one of the most sustainable textiles, growing hemp doesn't require irrigation or insecticide use. It is extremely fast growing, (up to four metres in just a couple of months) weeds don't stand a chance, don't hamper the growth of the hemp, and herbicides are not necessary. 100% biodegradable.

The fibres sequester carbon, locking it in and stopping it releasing back into the atmosphere, resulting in a very low-carbon product.

The high cellulose content (60 - 70%) of the plant makes it a very strong and durable material.



Hemp fabric

Hemp Linen Weave Natural
ET_H002_Natural

100% European Hemp, undyed, unbleached
Fire performance: No rating, treated by 3rd party

Contact

Marita Bartelet

info@ecologicaltextiles.com

www.ecologicaltextiles.com



Flat Hemp Panel

Composition: Hemp fibre bound with sugar based resin made from agricultural waste

Fire performance: Class B (self certified)



Corrugated Hemp Panel

Composition: Hemp fibre bound with sugar based resin made from agricultural waste

Fire performance: Class B (self certified)

Contact

Steve Barron

info@margentfarm.com

www.margentfarm.com

Tree derived



PineSkins

Start of life: Inner bark of pine trees, by product of commercial forestry.

End of life: Biodegradable. Potential for re-use.

Embodied Carbon: No data.

Fire performance: No fire rating, does not appear to be flammable during informal testing

Contact

Sarmite Polakova

sarmite.polakova@gmail.com

www.studiosarmite.com/



Cork Wall Tiles - Tobacco colour

Start of life: Regulated harvesting of bark from cork oak trees.

End of life: Recyclable, biodegradable.

Embodied Carbon: approx -116.229 kg CO₂ equivalent per m³

Fire performance: Euroclass E

Source

www.boardsdirect.co.uk

Similar alternative:

www.corkstore24.co.uk



Plywood

Starting life: Trees from commercial forestry

End of life: Can be shredded and recycled.

Embodied Carbon: -2.5kgCO₂/sqm

Fire performance: Class C-s1,d0 (confirm spec)

Thickness varies, min 12mm throughout

Guidance: Only source from FSC certified. Use boards with EO emissions class or formaldehyde free adhesives.



Honext

Starting life: Cellulose waste from paper recycling

End of life: Can be recycled in Honext manufacturing plant in Spain. Biodegradable.

Embodied Carbon:

Fire performance: Class C-s1,d0. *Will reach Class B-s1,d0 by Q2 2021 - tbc*

Contact

Álvaro Aznar

info@honextmaterial.com

<https://honextmaterial.com/>

Paints

The main environmental concern is the impact indoor air quality. Systems that use polymer (resin) binders or non-water based solvents release VOCs that are harmful to our health, and this should be a consideration in product selection.

Contact

Lakeland Paints

<https://www.lakelandpaints.co.uk/>

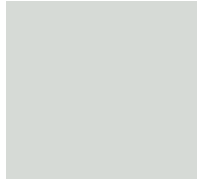

RAL 7047

Suggested wall colour for *Antechamber / Sanctuary of the Unseen Forest / Refuge for Resurgence / The Future is Ancestral / The Feral and The Sphere / The Symbiocene*



RAL 7009

Suggested wall colour for *Planet City / Queer Ecology / Noise Aquarium*



RAL 7045

Suggested wall colour for *A Biological Future for Fashion / Sharing Prosperity / Where Does Your Building Come From / The World Beneath Our Feet / 2040 - Sensible Zone / Stories of Change / Sonic Waterfall /*



Black paint, high gloss



Black paint, eggshell



RAL 7034



White paint, eggshell

Thank you